

CONCEPT SUMMARY

EXISTING ZONING = DC (DOWNTOWN COMMERCIAL)
 LOT AREA = 23,580 SF (.54 AC.)
 BUILDING AREA = 9,675 SF PER FLOOR
 TOTAL BUILDING AREA = 29,025 SF
 TOTAL UNITS = 24 UNITS
 1-BR = 6 UNITS
 2-BR = 12 UNITS
 3-BR = 6 UNITS
 PROVIDED PARKING = 42 STALLS



building strong communities.

1360 NW 121ST. Street
 Clive, Iowa 50325
 515-964-1229
 fax 515-964-2370

NOTICE:
 McClure Engineering Company waives any and all responsibility and liability for problems which arise from failure to follow these Plans, Specifications, and the engineering intent they convey, or for problems which arise from failure to obtain and/or follow the engineers guidance with respect to any errors, omissions, inconsistencies, ambiguities, or conflicts which are alleged.

COPYRIGHT:
 Copyright and property rights in these documents are expressly reserved by McClure Engineering Company. No reproductions, changes, or copies in any manner shall be made without obtaining prior written consent from McClure Engineering Company.

2ND AVENUE E.

S. 1ST ST.

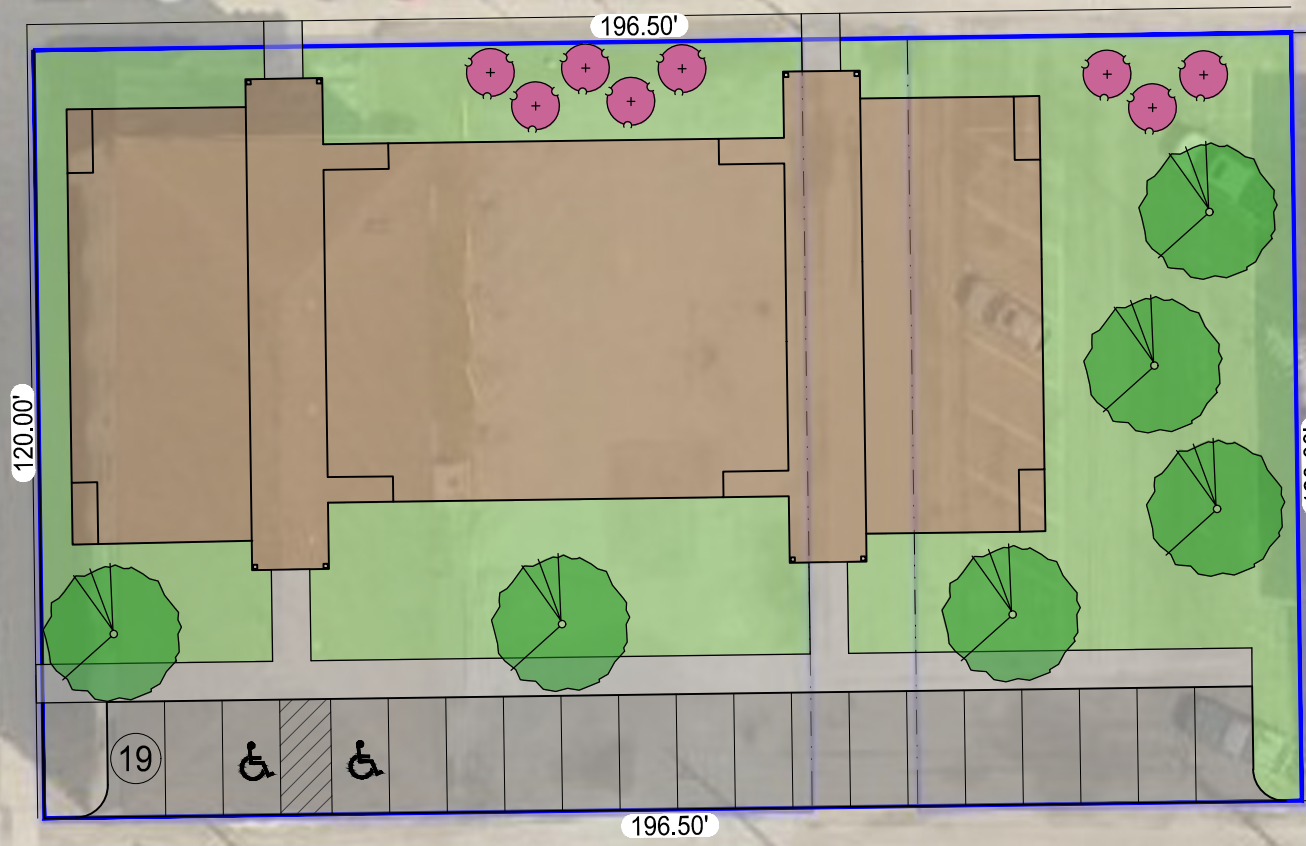

PRELIMINARY

CONCEPT 1



NORTH

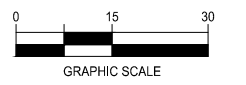

S. 1ST STREET AND
 2ND AVENUE E
 APARTMENT CONCEPT
 OSKALOOSA, IA
 21418013
 JANUARY 2019

REVISIONS

ENGINEER: C SMITH
 DRAWN BY: C SMITH

CHECKED BY: -
 FIELD BOOK NO.: -

DRAWING NO.: CP-01
 SHEET NO.: 01 / 01

N:\Projects\OSK\21418013\Design\Concept\Oskaloosa Apartment Concept 1-2019 0120.dwg
 1/20/2019 4:47 PM